

## Facilities Planning & Development

**Julie Arthur**, *Executive Director*

September 17, 2018

Dear Community Members of Vista Del Monte Elementary School,

In an effort to increase available shaded areas for outdoor activities the Palm Springs Unified School District (PSUSD) will be constructing a 30 x 64 foot metal shade structure on the elementary campus grounds. The structure has been positioned with input from the Principal and in compliance with applicable codes governing school construction. This improvement will allow for a variety of new opportunities on the campus grounds during recess or for organized outdoor events.

If you have questions or comments on this project, please send them to:  
**[facilities\\_planning@psusd.us](mailto:facilities_planning@psusd.us)**

Written comments and suggestions should be received by October 16, 2018. The comments and suggestions received will be shared with the Board of Education ("Board") and community members can speak directly to the Board concerning this project at the October 23, 2018 meeting. The Board meeting will be held at the District Office located at 150 District Center Drive, Palm Springs beginning at 6:00 PM.

If you have questions or need further information, please contact the Facilities Planning and Development office by dialing (760) 883-2710 and selecting Option 1.

Sincerely,



Julie Arthur  
Executive Director  
Facilities Planning and Development

JA:kh

Enclosures

## Facilities Planning & Development

**Julie Arthur**, Executive Director

17 de septiembre de 2018

Estimados Miembros de la Comunidad de la Escuela Vista Del Monte Elementary School,

En un esfuerzo por extender las áreas sombreadas disponibles para actividades al aire libre, el Distrito Escolar Unificado de Palm Springs (PSUSD) construirá una estructura de metal de 30 x 64 pies en los terrenos de la escuela primaria. La estructura se ha posicionado con el aporte del Director y a conformidad con los códigos aplicables que rigen la construcción de escuelas. Esta mejora permitirá una variedad de nuevas oportunidades en el plantel durante el recreo o para los eventos organizados al aire libre.

Si usted tiene preguntas o comentarios sobre este proyecto, envíelos a:

***[facilities\\_planning@psud.us](mailto:facilities_planning@psud.us)***

Se recibirán comentarios y sugerencias escritas antes de 16 de octubre de 2018. Los comentarios y sugerencias que se reciban se compartirán con la Junta de Educación ("Junta") y los miembros de la comunidad pueden hablar directamente con la Junta sobre este proyecto en la reunión de 23 de octubre de 2018. La reunión de la Junta tendrá lugar en la Oficina del Distrito que está ubicada en 150 District Center Drive, Palm Springs a partir de las 6:00 P.M.

Si usted tiene alguna pregunta o necesita más información, comuníquese con la Oficina de Planificación y Desarrollo de Instalaciones llamando a (760) 883-2710 y seleccionando la Opción 1.

Atentamente,

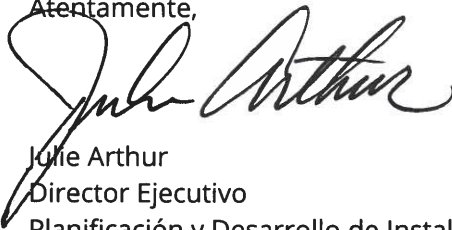

Julie Arthur  
Director Ejecutivo  
Planificación y Desarrollo de Instalaciones

JA:kh

Adjuntos



REVISIONS LOG

NO.	DATE	DESCRIPTION
01	04/11/2018	ISSUED FOR PERMIT
02	04/11/2018	ISSUED FOR PERMIT

CLIENT INFORMATION

CLIENT NAME	PRK
PROJECT NAME	VISTA DEL MONTE ELEMENTARY SHADE STRUCTURE
DATE	04/11/2018
NO.	001
DESCRIPTION	ACCESSIBILITY SITE PLAN

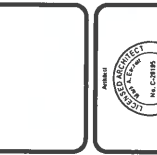

ACCESSIBILITY SITE PLAN

**PATH OF TRAVEL**

THE PATH OF TRAVEL IS THE ROUTE TAKEN BY AN INDIVIDUAL WITH A PHYSICAL OR SENSORY DISABILITY TO GET FROM ONE PLACE TO ANOTHER PLACE. THE PATH OF TRAVEL IS THE ROUTE TAKEN BY AN INDIVIDUAL WITH A PHYSICAL OR SENSORY DISABILITY TO GET FROM ONE PLACE TO ANOTHER PLACE. THE PATH OF TRAVEL IS THE ROUTE TAKEN BY AN INDIVIDUAL WITH A PHYSICAL OR SENSORY DISABILITY TO GET FROM ONE PLACE TO ANOTHER PLACE.

**ACCESSIBILITY LEGEND**

- RELO: RELOCATED EXISTING ELEMENT
- NEW: NEW ELEMENT
- EXIST: EXISTING ELEMENT
- DEM: DEMOLISHED ELEMENT
- CON: CONSTRUCTION ELEMENT

**ACCESSIBILITY KEYED NOTES**

1. ALL ELEMENTS SHALL BE ACCESSIBLE TO ALL INDIVIDUALS WITH PHYSICAL OR SENSORY DISABILITIES.

2. ALL ELEMENTS SHALL BE ACCESSIBLE TO ALL INDIVIDUALS WITH PHYSICAL OR SENSORY DISABILITIES.

3. ALL ELEMENTS SHALL BE ACCESSIBLE TO ALL INDIVIDUALS WITH PHYSICAL OR SENSORY DISABILITIES.

**DSA CERTIFICATION LIST**

1. THE FOLLOWING PROJECT IS ACCESSIBLE TO ALL INDIVIDUALS WITH PHYSICAL OR SENSORY DISABILITIES.

2. THE FOLLOWING PROJECT IS ACCESSIBLE TO ALL INDIVIDUALS WITH PHYSICAL OR SENSORY DISABILITIES.

3. THE FOLLOWING PROJECT IS ACCESSIBLE TO ALL INDIVIDUALS WITH PHYSICAL OR SENSORY DISABILITIES.

**PARKING CALCULATION**

REPAIRING LOT	1
NEW ACCESSIBLE SPACES	1
TOTAL ACCESSIBLE SPACES	1

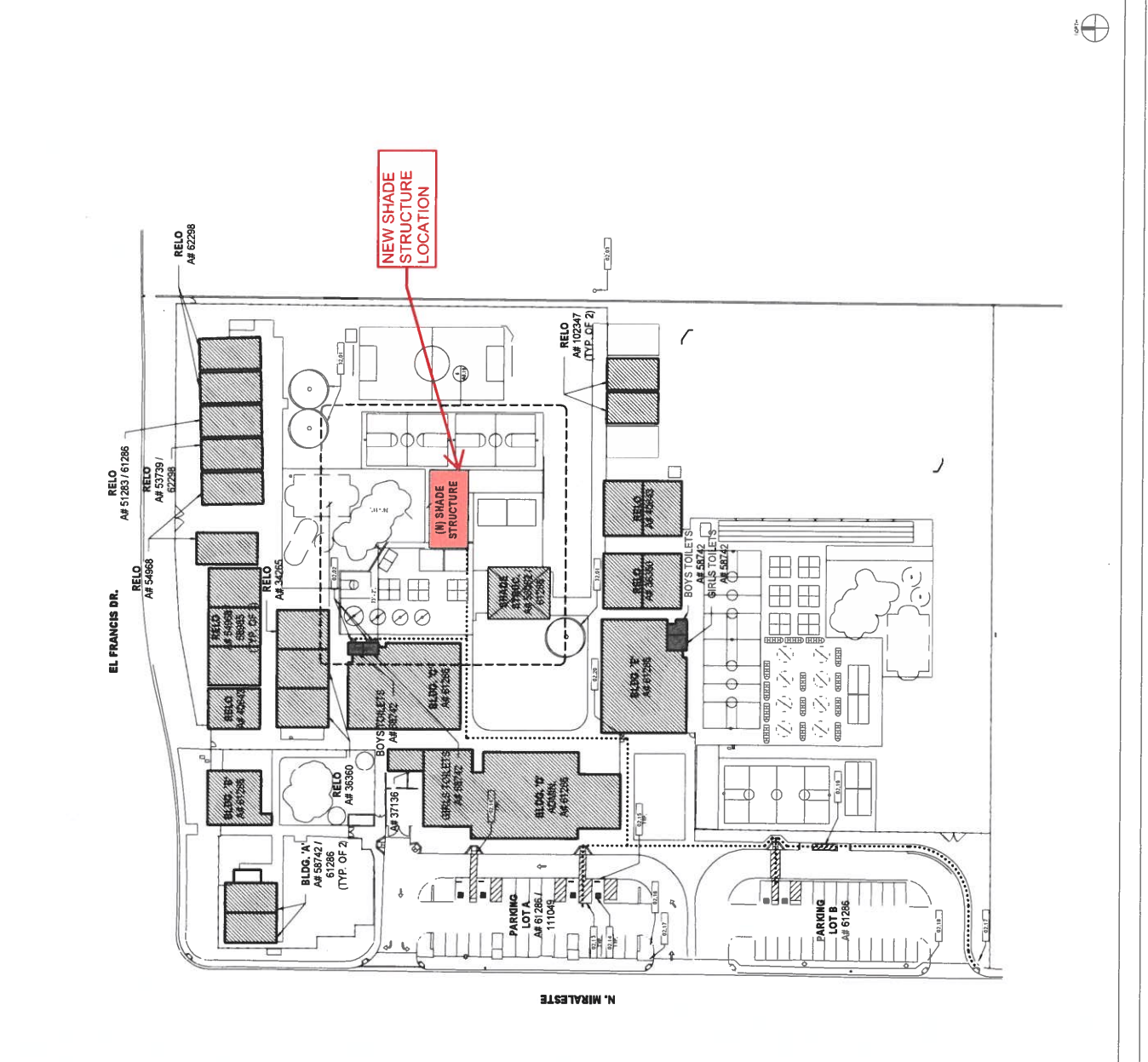



## SHADE STRUCTURE RENDERING

VISTA DEL MONTE ELEMENTARY SCHOOL  
2744 N VIA MIRALESTE, PALM SPRINGS, CA